

800 Series Low Power Flowmeter



This is a low power (4uA @ 3.3V) version of the 800 series turbine flowmeter, designed to give high performance and competitive pricing with 6 flow ranges from 0.05 to 15 litres per minute. Its totally non-metallic wetted components makes this flowmeter suitable for metering aggressive chemicals including ultra-pure water. The standard inlet tubes are barbed to accept a hose size of 8mm, the body is moulded PVDF and the 'O' ring seal is typically Viton™. The bearings are made of sapphire for long life and reliability.



IDEAL FOR

- Drink dispensing
- Batching
- Laboratory tests
- Cooling equipment
- Active flow alarms
- Semiconductor plant
- OEM applications



FEATURES

- Low cost
- PVDF body
- 1- 2% FSD
- Sapphire bearings
- Low power sensor
- 6 Flow ranges
- 10 bar rating
- Viton™ seal as standard
- 8mm hose tails
- 0.1% Repeatability
- 3.3 V 4uA
- -25°C Min to 80°C Max
- 50gms weight

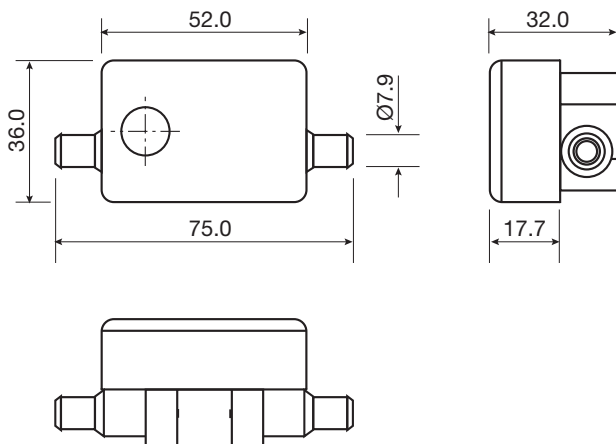

Ordering Codes

Model
803
815
845
865
810
824
Seal Materials
V = Viton™
N = Nitrile
E = EPDM
S = Silicon
Options
3 = 3.3 V
Body Material
P = PVDF
Calibration
O = Standard
U = Uncalibrated

e.g. **865-V3P-O** is a flow range of 0.25 to 6.5 L/Min, Viton™ seal, 3.3V, PVDF bodied flowmeter with a 6 point traceable water calibration.

Standard Materials of Construction

Body and cap	- PVDF
'O' Ring seal	- Viton™
Magnets	- PVDF coated ceramic
Bearings	- Sapphire

At the heart of the meter is a precision turbine that rotates freely on robust sapphire bearings and contains chemically resistant ceramic magnets that are detected through the chamber wall by a low power detector. The output is a stream of pulses that are readily interfaced with most electronic display or recording devices, such as Titan's Pulsite® Solo. This combination of materials and technology ensures a long life product with reliable operation throughout.



TECHNICAL SPECIFICATIONS

Model	Flow range L/Min	Linearity % FSD	Typical Freq. Hz.	Approx 'K' Factor
803	0.05 - 0.5	2.0	47	5650
815	0.12 - 1.5	2.0	58	2300
845	0.20 - 4.5	1.5	86	1150
865	0.25 - 6.5	1.5	76	700
810	0.30 - 10.0	1.0	78	470
824	0.50 - 15.0	1.0	81	325

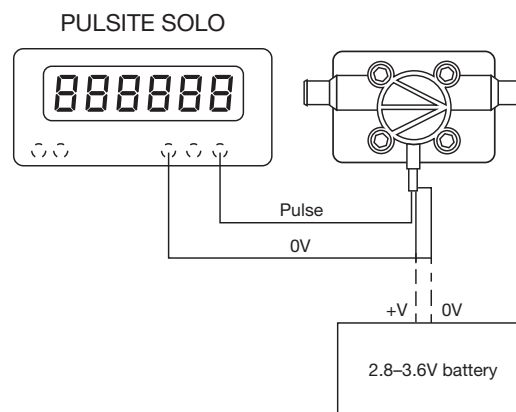

TITAN ENTERPRISES LTD.

Coldharbour Business Park, Sherborne, Dorset DT9 4JW

Tel: **+44 (0)1935 812790**

Email: **sales@flowmeters.co.uk**

Web: **www.flowmeters.co.uk**

For reference only; for latest information contact your local distributor.