

Simply a question of  
**better measurement**

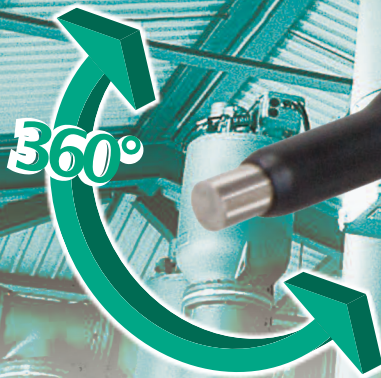

## SCHMIDT® HVAC 100

High-Quality Flow and Temperature  
Sensor for Air and Gases



SCHMIDT  
Technology  
HVAC 100  
548000  
Made in Germany  
 $w_v$  0-max. = 0-10 V  
 $T_w$  0-60 °C = 0-10 V

### Product Features

- ④ Easy-to-Install, without alignment to flow direction, variable immersion depth, extendable
- ④ Integrated evaluation electronics in the sensor tube
- ④ Operating status display via LED
- ④ Maintenance-Free, robust and long-term stable
- ④ Easy-to-Clean (anti-dust-design)

### Applications

- ④ Ventilation, exhaust and air-conditioning systems
- ④ Control of supply air and exhaust air in fume chambers
- ④ Filter monitoring



### Intercontrol

IJsselburcht 26  
6825 BP Arnhem  
Tel. +31 (0) 26 4425 204

[info@intercontrol.eu](mailto:info@intercontrol.eu)

# SCHMIDT® HVAC 100

Technical Data	
Measuring parameters	standard velocity $w_N$ of air, based on standard conditions 20 °C and 1013.25 hPa medium temperature $T_M$
Medium to be measured	air and gases
Measuring range $w_N$ Measuring accuracy <sup>1)</sup> $w_N$	0 ... 2.5 m/s ±(4 % of meas. value +0.05 m/s) 0 ... 10 m/s ±(4 % of meas. value +0.2 m/s) 0 ... 20 m/s ±(4 % of meas. value +0.4 m/s)
Lower detection limit $w_N$	0.2 m/s
Reproducibility $w_N$	±1.5 % of measured value
Measuring range $T_M$	0 ... +60 °C
Measuring accuracy $T_M$ ( $w_N > 2$ m/s)	±1 K (10 ... 30 °C); ±2 K in remaining interval
Response time ( $t_{90}$ ) $w_N$	approx. 10 s (jump from 0 to 5 m/s)
Operating temperature	-10 ... +60 °C
Humidity range	0 ... 95 % rel. humidity (RH), non-condensing
Operating pressure	atmospheric (700 ... 1,300 hPa)
Operating voltage $U_B$	24 V DC ± 20 %
Current consumption	typ. <35 mA (max. 80 mA)
Analog outputs	0 ... 10 V
Burden	$R_L \geq 10$ k $\Omega$ ; $C_L \leq 1$ nF
Electrical connection	non-detachable connecting cable, pigtail, length 2 m, 4-pin 0.25 mm <sup>2</sup> , PVC
Cable length (recommended)	15 m max.
Type of protection	IP 40
Protection class	III (SELV)
Min. immersion depth (MID)	35 mm
Dimensions	ø 12 mm, probe length 144 mm
Material	PC, ABS, Nickel-plated Brass
Weight	50 g (probe)
Delivery content	probe, mounting clamp, extension tube, manual

<sup>1)</sup> under conditions of the reference

**Extension Tube** Art.-Nr. 551300  
Extending length 85 mm, set of 5 pcs.



## Representation of the Analog Signal ( $w_N$ , $T_M$ )

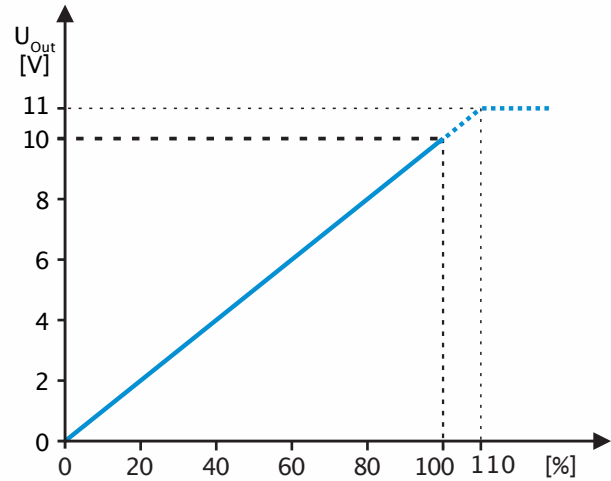

## Order Information

HVAC 100 - 2.5 m/s	548 000-13
HVAC 100 - 10 m/s	548 000-11
HVAC 100 - 20 m/s	548 000-12
Extension Tube (set of 5 pcs.)	551 300

## Mounting Clamp

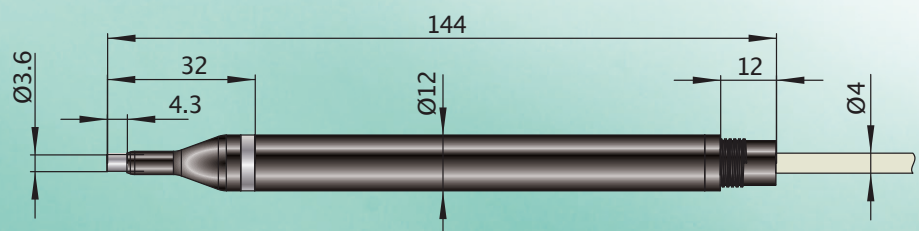
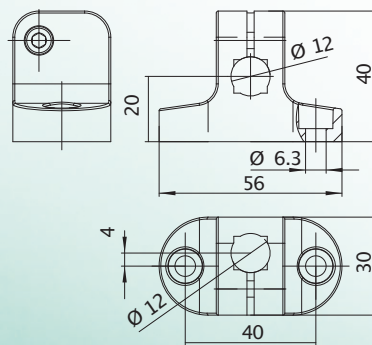

# SCHMIDT® HVAC 100

## Order information SCHMIDT® Strömungssensor HVAC 100

	Description	Article Number	
Basic sensor	SCHMIDT® Flow Sensor HVAC $w_N$ and $T_M$ , 0 ... 10 V, cable 2 m each including 1 x mounting bracket and 1 x extension tube	548 000 -1	Y
	<b>Options</b>		
Measuring range	Measuring range 0 ... 2.5 m/s		3
	Measuring range 0 ... 10 m/s		1
	Measuring range 0 ... 20 m/s		2
	Description	Article Number	
Accessories	Power supply unit 24 V DC /1 A output, supply voltage 115 /230 V AC	535 282	
	Extension tubes (5 pcs)	551 300	
	Assembly kit for pipe assembly suitable for MD 10.010/MD 10.015, including pipe clamps and collar for adjustment to the pipe diameter	531 394	
	SCHMIDT® LED display MD 10.010 in wall housing to show volume flow and flow velocity, 85 ... 250 V AC and sensor power supply	527 320	
	SCHMIDT® LED display MD 10.010, similar to 527 320 but with 24 V DC voltage supply	528 240	
	SCHMIDT® LED display MD 10.015, similar to 527 320 but with an additional sum function and a second measuring input	527 330	
	SCHMIDT® LED display MD 10.015, similar to 527 330 but with 24 V DC voltage supply	528 250	